

▼ SWITCH FUNCTION

No. Poles	Model No.	Switch Function		Connected Terminals / Schematic	
		POS. 1	POS. 2	POS. 1	POS. 2
SP	FKS7	ON	(ON)	2-1	2-3
	FKSL	ON	ON		
DP	FKD7	ON	(ON)	2-1, 5-4	2-3, 5-6
	FKDL	ON	ON		
3P	FK37	ON	(ON)	2-1, 5-4, 8-7	2-3, 5-6, 8-9
	FK3L	ON	ON		

()=Momentary

▼ POLE OPTIONS

FK
Pushbutton Switches

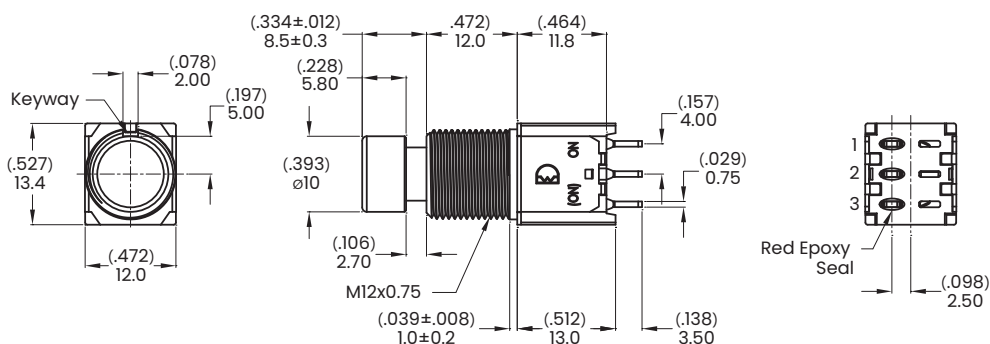

SPDT

Model name. FKS7P10B1C3MIQES

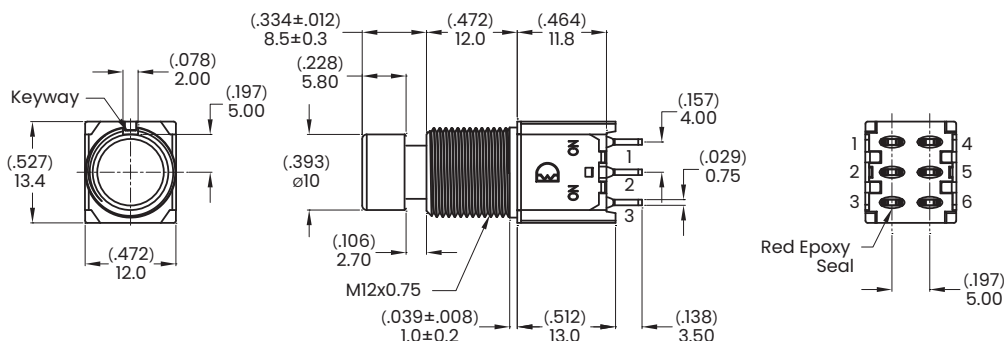

DPDT

Model name. FKDLP10B1C3M2QES

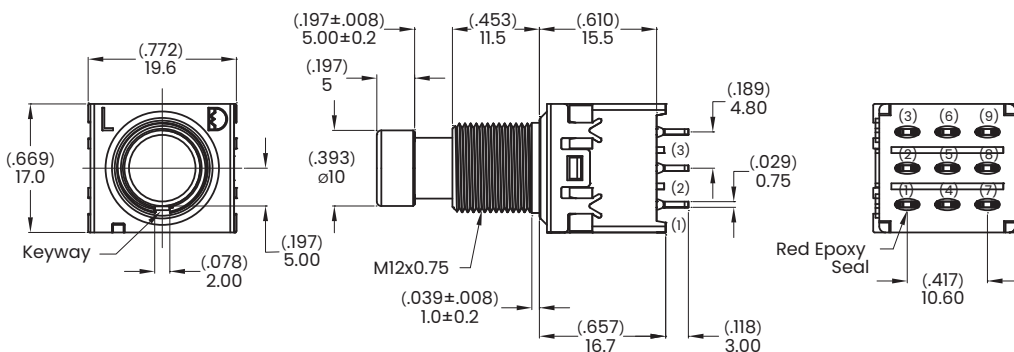

3PDT

Model name. FK3LP20B2C3M2QES

Model name. FK-PIB1-5

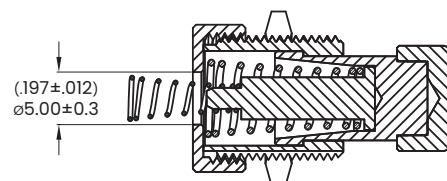
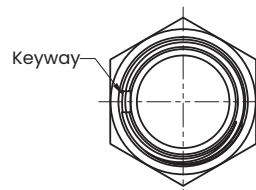
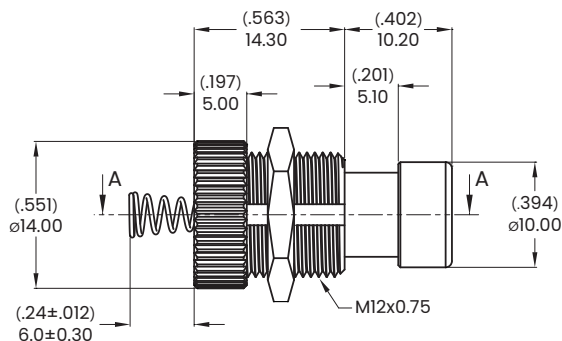

Note:

1. Working force of bushing with nut: Test with torsion meter and increase torsion over 8 kgf.
2. Keep the nut's torsional strength in 8 kgf.

▼ PANEL MOUNTING

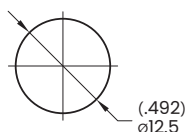

▼ TERMINAL OPTIONS AND PCB MOUNTING

M1 Solder lug

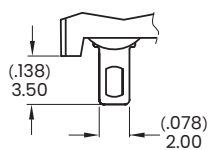

0.75 mm (.029 inch) THK
Note:
For 3P: -0.3 mm (.012 inch)

M2 PC Thru-hole

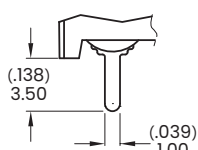

0.75 mm (.029 inch) THK
Note:
For 3P: -0.5 mm (.020 inch)

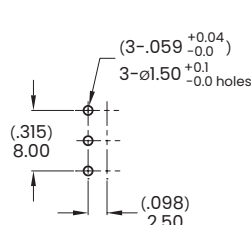

SP

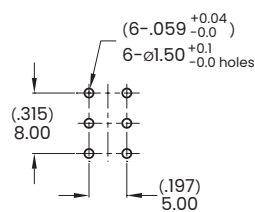

DP

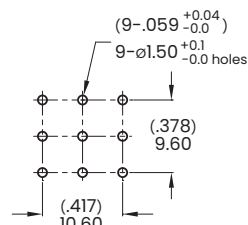

3P

▼ HARDWARE

EXAMPLE: -
Model name. 5 Standard hardware

* Standard hardware : 2 Nuts, 1 Locking Ring, 1 Washer
* For further information please consult sales representative.

Hex Nut

Model name. MNU-PA03

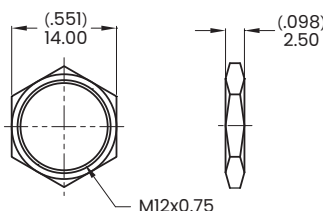

Washer

Model name. MNU-7K01

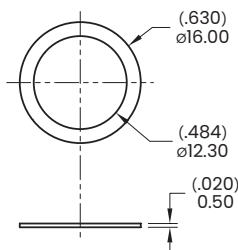

Lock Washer

Model name. MNU-1M09

